

# Door Limit Switches



NEMA1 to NEMA9 Models

atmosphere is everything

14716 S. BROADWAY, GARDENA, CA 90248 • Ph: (310)532-1555 Fax: (310)-532-3030 • [www.marsair.com](http://www.marsair.com)  
© Copyright Mars Air Systems, LLC 2014

## Door Limit Switches

| Door Switch Number | Description                              | Voltage | Phase | HP  | Amperage | Poles | NEMA Rating |
|--------------------|--|---------|-------|-----|----------|-------|-------------|
| 99-012             | Standard Combination Plunger Type        | 250V    | 1     | 1   | 20       | 1     | NEMA 1      |
| 99-013             | Standard Roller Type                     | 250V    | 1     | 1   | 20       | 1     | NEMA 2      |
| 99-014             | Standard Combination Plunger/Roller Type | 250V    | 1     | 1   | 20       | 1     | NEMA 3      |
| 99-015             | Washdown Roller Type                     | 250V    | 1     | 3/4 | 20       | 1     | NEMA 4X     |
| 99-267             | Washdown Roller Type                     | 250V    | 1     | 1/2 | 10       | 1     | NEMA 4X     |
| 99-016             | Explosion Resistant 1 Roller Type        | 250V    | 1     | 3/4 | 20       | 1     | NEMA 7 & 9  |

### Features:

- ❖ UR (UL Recognized) and rated for NEMA 1 (field installed by others)
- ❖ Combination plunger/Roller (99-014), Plunger (99-012) & Roller Type (99-013) door limit switches available to suit various applications
- ❖ Only available for 115V, 208V or 230V, 1Ø power (If any of the ratings are exceeded, an optional motor control panel must be used)
- ❖ Maximum ratings of 1 HP, 250V and 20A
- ❖ Single pole terminal (1P) normally closed (NC) and normally opened (NO) contact. Only the NC terminals are used and provided with terminal screws
- ❖ Used when automatic control of an air curtain(s) is required
- ❖ Turns the air curtain on when the door opens and off when the door closes
- ❖ Requires less than 1/8" of travel or 2 lbs. of force on the switch plunger to energize and de-energize the air curtain
- ❖ 1/2" FPT conduit connection (field wired by others)
- ❖ (2) 11/64" mounting holes provided\*

\*Do not use a fastener larger than a #6 sheet metal screw or a #8 Machine screw to mount this door limit switch. Forcing larger screws through the mounting holes destroys the switch and voids the warranty.

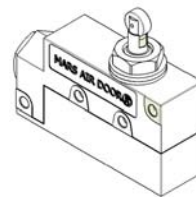

99-014 – Combination Plunger/Roller Type

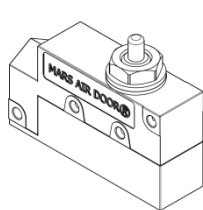
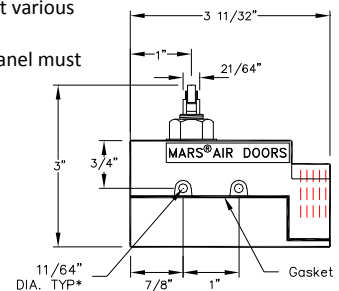

99-012 - Plunger Type

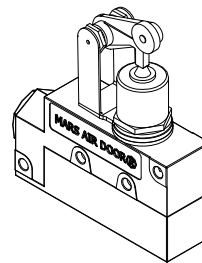
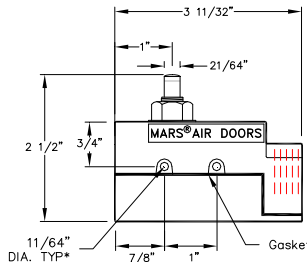

99-013 - Roller Type

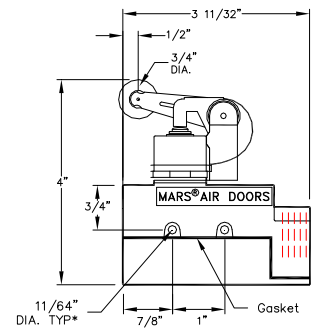

### Options and Accessories: (see Accessories Brochure)

#### Washdown

- ❖ UR (UL Recognized) and rated for NEMA4X/IP55 (field installed by others)
- ❖ Roller Type 99-267 are rated for 250V, 10A, 1/2 HP
- ❖ Roller Type 99-015 are rated for 250V, 20A, 3/4 HP

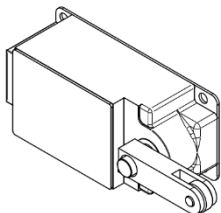

99-015 – Washdown Roller Type

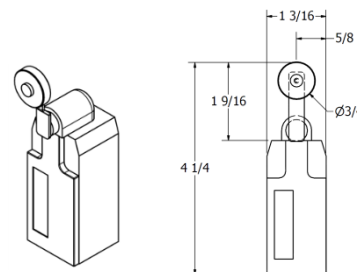
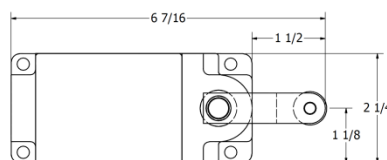

99-267 – Washdown Roller Type

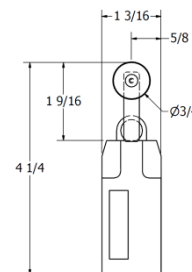

#### Explosion Resistant

- ❖ UR (UL Recognized) and rated for NEMA 7 & 9 (Class 1, Division 1, Group D) (field installed by others)
- ❖ Roller Types 99-016 are rated for 250V, 20A, 3/4 HP

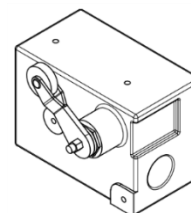

99-016 – Explosion Resistant Roller Type

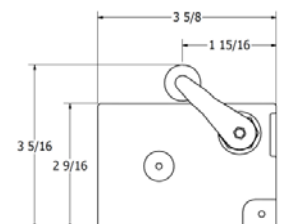

NOTE: MARS AIR SYSTEMS, LLC reserves the right to change specifications and product design without notice. Such revisions do not entitle the buyer to corresponding changes, improvements, additions or replacements for previously purchased equipment.